



WYNDHAM PLAZA

PROJECT PROFILE

SEPTEMBER 2, 2004



OVERVIEW:

- 38 acres
- Zoning: "S-P-2" Generalized Site Plan District with "C-3" General Commercial District uses.
- 341,000 s.f. of retail and restaurant uses
- Grand Opening - March 2001

CONCEPT: Wyndham Plaza is a comprehensively planned development incorporating over 341,000 square feet of retail and restaurant space. The project includes seven buildings and four pad sites.



LOCATION: The Wyndham Plaza project is located on approximately 38 acres south of State Highway 114 and north of East Southlake Boulevard (F.M. 1709), approximately 1000' east of North Kimball Avenue. The extension of Nolen Drive, connecting State Highway 114 to F.M. 1709, was constructed with this development.

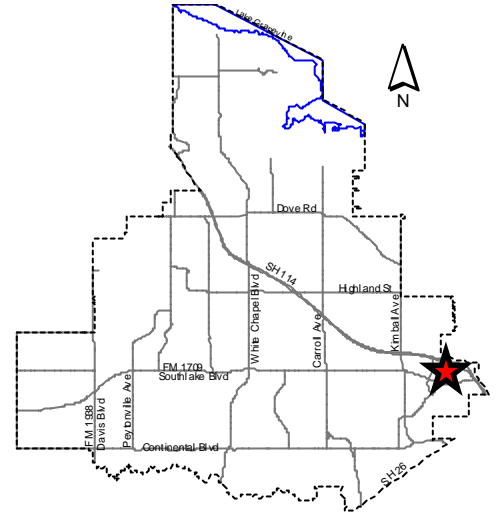

TENANTS: (Confirmed as of September 2004)

- Costco
- Buca di Beppo
- Car Toys
- Vitamin Shoppe
- Global Converging Technologies
- Einstein Brothers Bagel
- Hest Fitness Equipment
- EB Games
- New Balance DFW
- Camille's Sidewalk Café
- Peyton Thomas Salon
- The UPS Store
- The Customer Center (Nextel)
- Johnny B's Burgers and Shakes
- Steak-n-Shake
- Bath Junkie

CONTACTS: The following contacts are familiar with the Wyndham Plaza project:

Developer

Wyndham Properties, Ltd.
Terry Wilkinson, President
(817) 329-4599

City of Southlake

Economic Development Department
(817) 748-8039
econdev@ci.southlake.tx.us
www.southlakesites.com

Leasing

Canyon Partners
Jim Pangman
(214) 346-0660